

|                      |   |
|----------------------|---|
| <b>Room Name</b>     | = Chancel                                     |
| Area                 | = 35m <sup>2</sup>                            |
| Type of System       | = IDEAL EPS 125mm Centres                     |
| No. of Circuits      | = 5   |
| No. of Thermostats   | = 0   |
| Additional Items     | = Slate 30mm, Fermacell 20mm & 50mm Styrozone |
| Load Bearing Surface | = SRT Unseen Floor                            |
| Final Floor Finish   | = Stone                                       |

|                      |   |
|----------------------|---|
| <b>Room Name</b>     | = Main Area                                   |
| Area                 | = 220m <sup>2</sup>                           |
| Type of System       | = IDEAL EPS 125mm Centres                     |
| No. of Circuits      | = 15  |
| No. of Thermostats   | = 0   |
| Additional Items     | = Slate 30mm, Fermacell 20mm & 50mm Styrozone |
| Load Bearing Surface | = SRT Unseen Floor                            |
| Final Floor Finish   | = Stone                                       |

5 Way Mixing Manifold on a backboard

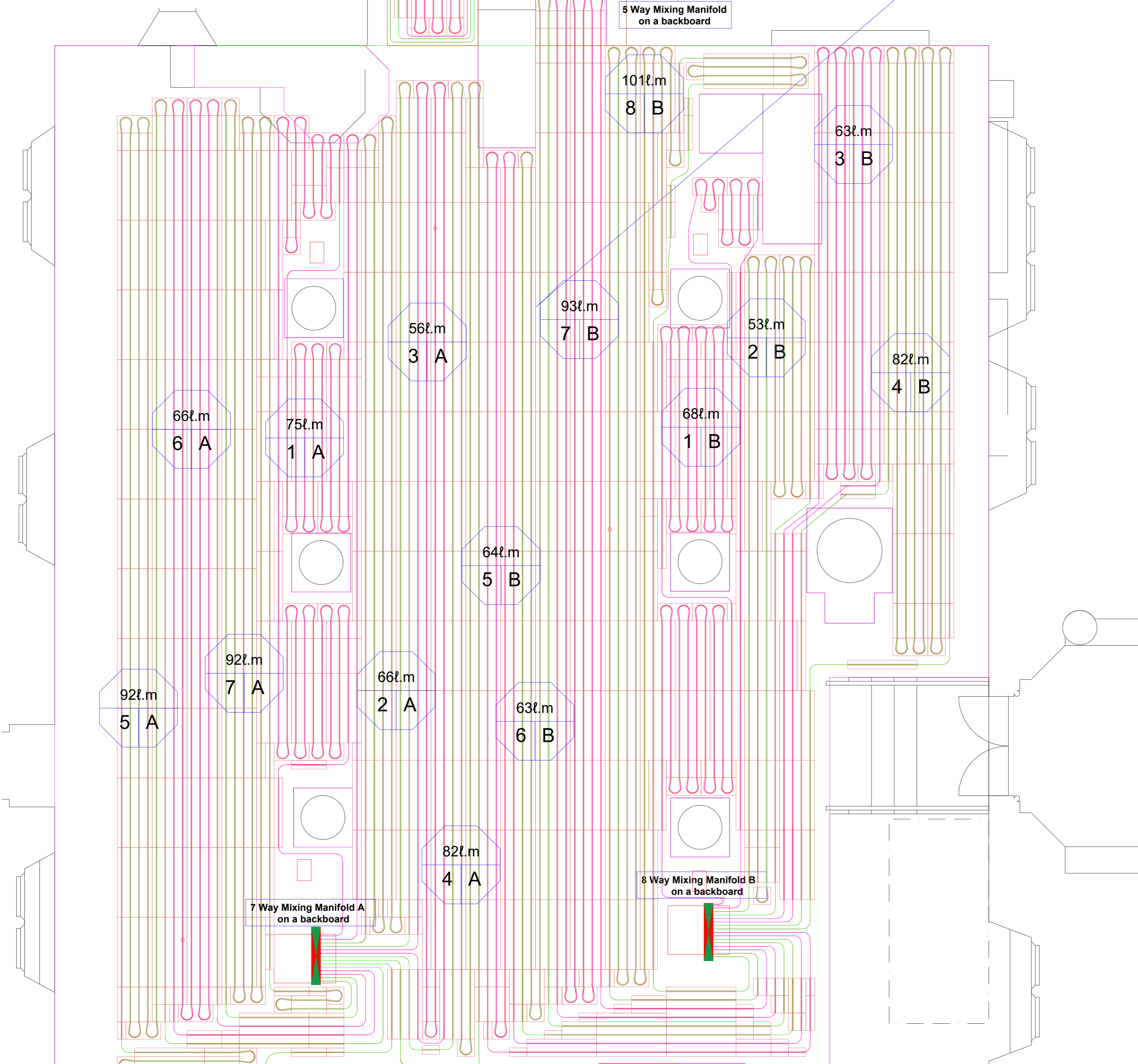

7 Way Mixing Manifold A on a backboard

8 Way Mixing Manifold B on a backboard

RAMP

STEP

|                      |   |
|----------------------|---|
| <b>Room Name</b>     | = Kitchen                                     |
| Area                 | = 16m <sup>2</sup>                            |
| Type of System       | = IDEAL EPS 125mm Centres                     |
| No. of Circuits      | = 4   |
| No. of Thermostats   | = 0   |
| Additional Items     | = Slate 30mm, Fermacell 20mm & 50mm Styrozone |
| Load Bearing Surface | = SRT Unseen Floor                            |
| Final Floor Finish   | = Stone                                       |

4 Way Mixing Manifold on a backboard

RAMP

4 D

